

MOTORE ELETTRICO - ELECTRIC MOTOR					
Grandezza Size IEC	Potenza in kw Power in kw			L ^(a) [mm]	Peso ^(a) Weight [kg]
	2 Poli 2 Poles	4 Poli 4 Poles	6 Poli 6 Poles		
80	0.75	0.55	0.37	232	9
80	1.1	0.75	0.55	232	10
90	1.5	1.1	0.75	245	13
90	2.2	1.5	1.1	270	16
100	3	2.2	1.5	298	21
100	-	3	-	298	23
112	4	4	2.2	312	30
132	5.5	5.5	3	381	40
132	7.5	7.5	4	381	50
132	9.2	9.2	5.5	381	50
160	11	11	7.5	486	76
160	15	15	11	486	85
160	18.5	-	-	486	95
180	22	18.5	-	576	125
180	-	22	15	576	145

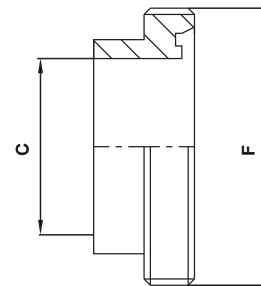

DIN 11851		
DN	C	F
25	25,0	52x1/6
32	31,0	58x1/6
40	37,0	65x1/6
50	49,0	78x1/6
65	66,0	95x1/6
80	81,0	110x1/4
100	97,6	130x1/4

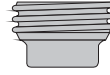

Pompa tipo Pump size	Motore Elettrico Electric Motor IEC	DIMENSIONI - DIMENSIONS [mm]															Peso ^(b) Weight [kg]
		Pompa - Pumps						Piedi - Feet									
		DNa	DNm	a	f	h1	h2	b	c	m1	m2	n1	n2	s1	s2	w	
25-16	80	40	25	76	194	155	161	23	75	300	220	203	183	10	3	184	15
	90	"	"	"	194	165	"	23	75	300	220	216	198	10	3	190	15
	100	"	"	"	214	155	"	25	55	280	200	240	218	12	3	247	21
	112	"	"	"	214	167	"	25	55	280	200	270	248	12	3	254	21
32-16	80	50	32	95	194	155	175	23	75	300	220	203	183	10	3	184	18
	90	"	"	"	194	165	"	23	75	300	220	218	198	10	3	190	18
	100	"	"	"	214	155	"	25	55	280	200	240	218	12	3	247	24
	112	"	"	"	214	167	"	25	55	280	200	270	248	12	3	254	24
	132	"	"	"	234	162	"	29	30	340	220	326	304	14	4	283	24
32-20	VEDI RS 32 - 20 SEE RS 32 - 20																
40-16	80	65	40	97	198	155	175	23	75	300	220	203	183	10	3	188	20
	90	"	"	"	198	165	"	23	75	300	220	218	198	10	3	194	20
	100	"	"	"	218	155	"	25	55	280	200	240	218	12	3	251	26
	112	"	"	"	218	167	"	25	55	280	200	270	248	12	3	258	26
	132	"	"	"	238	162	"	29	30	340	220	326	304	14	4	287	26
40-20	VEDI RS 40 - 20 SEE RS 40 - 20																
50-16	80	80	50	133	203	155	195	23	75	300	220	203	183	10	3	193	21
	90	"	"	"	203	165	"	23	75	300	220	218	198	10	3	199	21
	100	"	"	"	223	155	"	25	55	280	200	240	218	12	3	256	27
	112	"	"	"	223	167	"	25	55	280	200	270	248	12	3	263	27
	132	"	"	"	243	162	"	29	30	340	220	326	304	14	4	292	27
	160	"	"	"	273	210	"	45	50	500	350	404	364	15	5	311	32
50-20	80	80	50	133	221	155	215	23	75	300	220	203	183	10	3	211	27
	90	"	"	"	221	165	"	23	75	300	220	218	198	10	3	217	27
	100	"	"	"	238	155	"	25	55	280	200	240	218	12	3	271	33
	112	"	"	"	238	167	"	25	55	280	200	270	248	12	3	281	33
	132	"	"	"	261	162	"	29	30	340	220	326	304	14	4	310	33
	160	"	"	"	291	210	"	45	50	500	350	404	364	15	5	329	41
65-16	80	100	65	143	230	155	217	23	75	300	220	203	183	10	3	220	29
	90	"	"	"	230	165	"	23	75	300	220	218	198	10	3	225	29
	100	"	"	"	250	155	"	25	55	280	200	240	218	12	3	282	35
	112	"	"	"	250	167	"	25	55	280	200	270	248	12	3	290	35
	132	"	"	"	270	162	"	29	30	340	220	326	304	14	4	318	35
	160	"	"	"	300	210	"	45	50	500	350	404	364	15	5	338	43
65-20	90	100	65	143	229	190	242	30	100	370	220	234	207	12	3	225	35
	100	"	"	"	249	200	"	30	100	370	220	254	227	12	3	272	41
	112	"	"	"	249	212	"	30	100	370	220	284	257	12	3	279	41
	132	"	"	"	269	212	"	31	80	400	300	325	298	12	4	278	41
	160	"	"	"	299	210	"	45	50	500	350	404	364	15	5	337	49
	180	"	"	"	299	230	"	45	50	500	350	429	389	15	5	365	49
80-16	90	125	80	170	236	190	258	30	100	370	220	234	207	12	3	232	37
	100	"	"	"	256	200	"	30	100	370	220	254	227	12	3	279	43
	112	"	"	"	256	212	"	30	100	370	220	284	257	12	3	286	43
	132	"	"	"	276	212	"	31	80	400	300	325	298	12	4	285	43
	160	"	"	"	306	210	"	45	50	500	350	404	364	15	5	344	51
	180	"	"	"	306	230	"	45	50	500	350	429	389	15	5	372	51
80-20	90	125	80	170	236	190	283	30	100	370	220	234	207	12	3	232	40
	100	"	"	"	256	200	"	30	100	370	220	254	227	12	3	279	46
	112	"	"	"	256	212	"	30	100	370	220	284	257	12	3	286	46
	132	"	"	"	276	212	"	31	80	400	300	325	298	12	4	285	46
	160	"	"	"	306	210	"	45	50	500	350	404	364	15	5	344	54
	180	"	"	"	306	230	"	45	50	500	350	429	389	15	5	372	54

Quote e pesi suscettibili di variazione.
Dimensions and weights are subject to variations.

^(b)Peso senza motore elettrico
Weight without electric motor